

Ida B. Wells HS Modernization Comprehensive Planning Committee Meeting 3

December 6, 2023





MEETING DETAILS

Location: Ida B Wells-Barnett High School, 1151 SW Vermont St, Portland, OR 97219

Date: Wednesday December 6, from 6:00 PM - 8:00 PM

PARTICIPANTS

Comprehensive Planning Committee Members

Don Baack
Amanda Brohman
Scott Burns
Ayesha Coning
Jon Duncan
Niko Fisque
Byron Groveline
Kristin Kolasinski
Leanne Lebare
Jeffrey Matson
Jamie Miler
Martin Osborne
Jazzmin Reece
Emilee Refvem
Matthew Regonini
Winston Rivas
Andrew Scott
Jeremy Shetler
Christie Totten
Cesar Michael Villanueva
Elektra Wood

Portland Public Schools

Donna Bezio
Rolando Aquilizan
Erik Gerding
Hector Lopez

Members of the Public

N/A

Design Team

Amy Donohue, Bora
Stefee Knudsen, Bora
Amelie Reynaud, Bora
Amy Running, Bora
Corey Squire, Bora
Aisha Marcos, Bora
Becca Cavell, Bora
Chelsea McCann, Walker Macy
Taryn Wiens, Walker Macy
Thy Daniels, After Bruce
Mireaya Medina, After Bruce
Rhonda Teeny, After Bruce

Objectives & Lookahead

Stefee reviewed the agenda for the meeting and outlined the objectives which include:

- Discussing CPC reactions to the draft Guiding Principles that have been shared out to the Committee
- Hearing CPC input on three Site Approach options the design team will share at this meeting, to inform a single option that will ultimately be forwarded to the Board

The committee will be asked to consider:

- The EXPERIENCE: what is special and unique?
- The FUNCTION: where are key elements?

Specifically:

- where is the front door? how will people arrive?
- to move or keep the track & field in current place?
- to move or keep the pool in its current place?

This team’s work is about the physical space, not how it’s managed or what sort of classes are offered

The team is keen to learn about what’s special, unique, and how should the new building feel

Schedule review >>>

Still early in the current Phase 1 “Conceptual Design” process, looking at lots of options to take to the Board

This phase is just the first of several design phases. After this phase, there will be 18-24 months of design followed by the construction effort

All of this depends on Board decisions around the bonds, etc

Debrief on Tours of Lincoln High School

CPC Members were invited to share their thoughts about the two recent tours:

- Really impressed by the 6 story structure and the two story area. The way the lower space met higher seismic performance, and offers a community resiliency space. Likes this is “beyond code”
- Great design! Library as a showcase for passersby, with views out for folks in the room; concerned about mesh at stair; loved gym with wrestling mats stored overhead; appreciated HVAC system and healthy materials, and location of spaces needing specialized venting on the upper floors [labs, etc]
- Each of the rooms had a specific design purposed; Choir room connections to other spaces; labs and robotics; lunch room/break room blend looked really good , with moveable walls. Liked re-use of Gundersen rail car floors on walls. Like the odd spaces for students to gather; liked windows and skylights; good thinking around public and less public spaces; saw no problem with 6 story school, and how different floors can focus on different specialties; appreciates how the design

had to accommodate challenging site constraints; liked more fields [practice field] rather than more parking; likes covered bike parking; passing trains didn’t seem to be a problem and add to the ‘urban flair”

- Stairs are very noisy - can this be mitigated?; 76 parking spaces is fine for an urban school but not IBW; plugs for charging spaces at bike parking area ; generators but no water and food storage for folks
- Parent: likes the space but has heard rumblings from students
- Student: didn’t feel like a school. Missed the big numbers over the doors. Was really big
- Staff: heard that the design didn’t originally include college and career counseling and had to add it later, on the second floor
- Student: why does the school feel hostile to disabled people? Why does the school need to be 6 stories tall?
- Continual learning from past projects is really important - gym/weight room / locker room relationship at LHS is challenging
- Question: will there be an opportunity to have “collegial challenges” from other HSs? Erik: yes!
- Kudos to Erik G as the tour guide!!

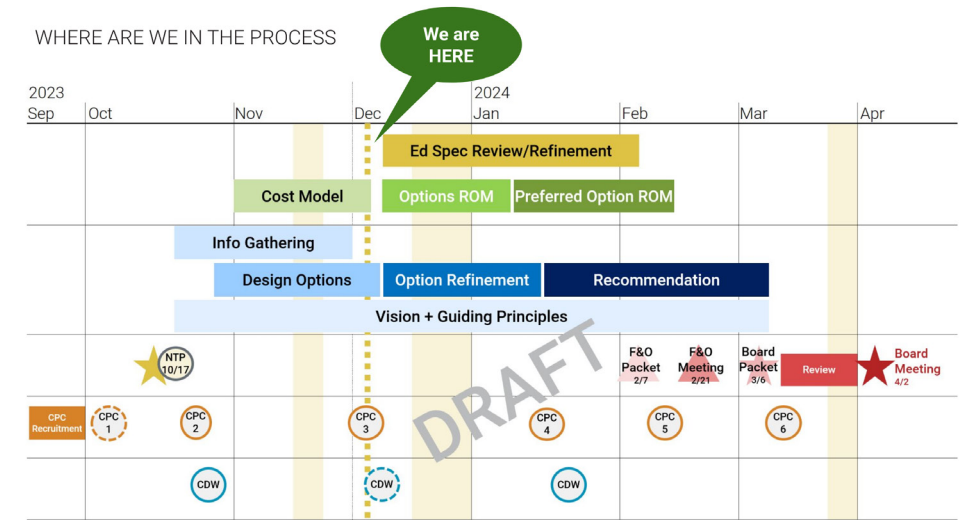

Reactions to Guiding Principals

Amy Donohue reviewed the DRAFT Guiding Principals and invited the CPC members to share their thoughts:

- The best way to build trust is to implement the suggestions - don't just listen: act.
- When with the actual design be available for feedback? Was on North Williams realignment program and the process was shut down as community began to show up at meetings. Alta's initial plan was changed due to this work
- Amplify language around future thinking, forward thinking - reflecting Ida B. A lot of folks at IBW worry they'll just get the same product
- If we have 10 Guiding Principles we'll be graded on each one, and what does a "10" look like. Also, which ones are prioritized. And, recognize when the intersect or conflict
- Transparency is really important - less construction speak, school speak, understandable to anyone in the community.
- Community use of facilities - for example the theater
- For "Connect": also accommodate people moving through the campus including during construction - important to the community and local businesses

[discussion ended at 6:37 but folks are encouraged to share more thoughts / add more comments]

DRAFT Guiding Principals:

CREATE a bold, flexible teaching environment that will inspire and support a variety of learning styles well into the future.

DEVELOP dynamic habitats for teenagers and teachers, supporting their social need to connect with one another as part of the path to teaching and learning success.

GATHER students, faculty, and staff in a safe environment where they feel a sense of pride and belonging, coalescing the community within a central "heart" while creating a variety of flex spaces to offer choice.

SUPPORT learning with great daylighting, healthy indoor air quality and excellent acoustics.

LIFT the voices of a diverse student body, empowering and making visible the many cultures within the community through meaningful, equity-informed, impactful engagement.

LEAD by example in creating the most sustainable school in the State of Oregon, fully compliant with the PPS Climate Action Policy while employing simple and easily maintained systems within enduring functional spaces.

EMBRACE the lens of disability justice to create a school that is universally accessible, going beyond code to create a physical place of inclusion at the site and building scale.

HONOR the legacy of Ida B Wells through design, art and storytelling within the building and on the site.

CONNECT to the broader business and residential district by making the new school a focal point and beacon of activity in SW Portland – all while preserving security and safety for the student population.

SEEK input from a broad set of voices throughout the process of design, respecting the truth of lived experience while elevating the most marginalized members of the community through trust-building

Site & Building Orientation

Corey Squire introduced his role as sustainability director at Bora and that this is the first of many opportunities he will be sharing sustainability focused topics with this group.

- Energy: effectively managing solar energy results in less energy needed to heat and cool the building
 - + Orientation matters related to the solar orientation.
 - + Topography and Views
 - + Sun - most important as we can't control and affects
 - + Human comfort, operating costs, occupant experience
 - + Southern sun exposure can be controlled
 - + West is hardest to control - similar to the orientation here in this space
 - + Designing with nature vs. disregard for nature (pull bullets from slide)
 - + We can't control - sun rises in East and sets in West, and we know exactly where the sun will be at any given moment
 - + Blinds can control but block views
 - + Bora examples of orienting glazing to avoid glare, windows in optimal orientations, shading devices to help control glare
 - + Sun path over sight noting the exposure



Existing Site Circulation & Topography

Chelsea McCann from Walker Macy, (Landscape Architecture) discussed current site conditions:

- Main entry for school is Vermont as well as yellow busses
- Most bus routes and many visitors arrive off of Capitol Highway. There is a north/south trails route between the East/West path along Burlingame
- Comments
 - + Other path travels to the shopping center or the transit path
 - + Paths are intentionally not meant for cars
 - + Speed bumps and drive between Rieke are difficult for cars
- Aerial plan of the site, highlights the main components that needs be accounted for in the site options
- Trees maybe impacted depending on the site, but two are accounted for in each plan.
 - + Beech tree near Vermont
 - + North tree on site
- Topography
 - + There is a lot of elevation change across the site.
 - + The school is the high point, 25' above the lower fields.
 - + Will impact accessibility throughout the site
 - + 35' difference between Rieke and baseball field
- Discussion:
 - + Ground water should be considered on the site
 - + Flooding of Fano creek, is there any retaining or diverting of water from the site being considered. Chelsea noted that it is still early and will be looking at those.
 - + Is there a limit on impervious area on site of a future design vs. existing and storm water retention and treatment. Chelsea noted that retention and treatment requirements are different than when the school was originally built.

Site Options

Amelie introduced three site development options:

The existing school will remain operational during construction of new school. Therefore, the buildable area is west of the existing school. Drawing from the guiding principles and the analysis of the site, the design team has developed three ideas for the site that offer different opportunities for the building.

Option 1 - "Gather"

- Places building between the existing sports field and West of the existing school
- Lower intervention of site work.
- More compact scheme, and would be up to 4 stories that would have distant views
- Keeping existing track, pool and fields would have minor improvements.
- Internal courtyard - provides more light and secure outdoor space for students
- Pool will require a new support structure to support
- Multi use field, New pickle ball court and relocated
- Cross section through the site shows a general idea of how the site elements would related to one another vertically.

Discussion

- With parks and recreation operating the pool, who would be responsible for the maintenance of a new stand-alone building.
 - + Erik noted that discussions have started with P&R but there is not clear path yet.
- What is the relationship with P&R
 - + Erik noted that they do need to be worked with
- Is pool deeded to PPS?
 - + Erik, there are inner governmental agreements between P&R and that could change if changes are made to the site.

Chelsea noted:

- Clear N/S circulation between school, fields and pool
- Parking at both N & S of site
- Teaching garden would be relocated

Discussion

- Comment: it would be hard to relocate the teaching garden.
- Q: Does anyone use the multi-sport field?
 - + A: Noted that the multi-sport field is used and an ed spec requirement
- Q: related to parking, is there a goal to make sure there is not an N/S cross through at the East of the site?
 - + A: All schemes assume this, but if this poses a problem please capture your comment on sides
- Parking count is not final, and will be further refined as options are developed.

Design team shared 3D views of the site configuration with some precedent images

SCHEME 1 - "GATHER"

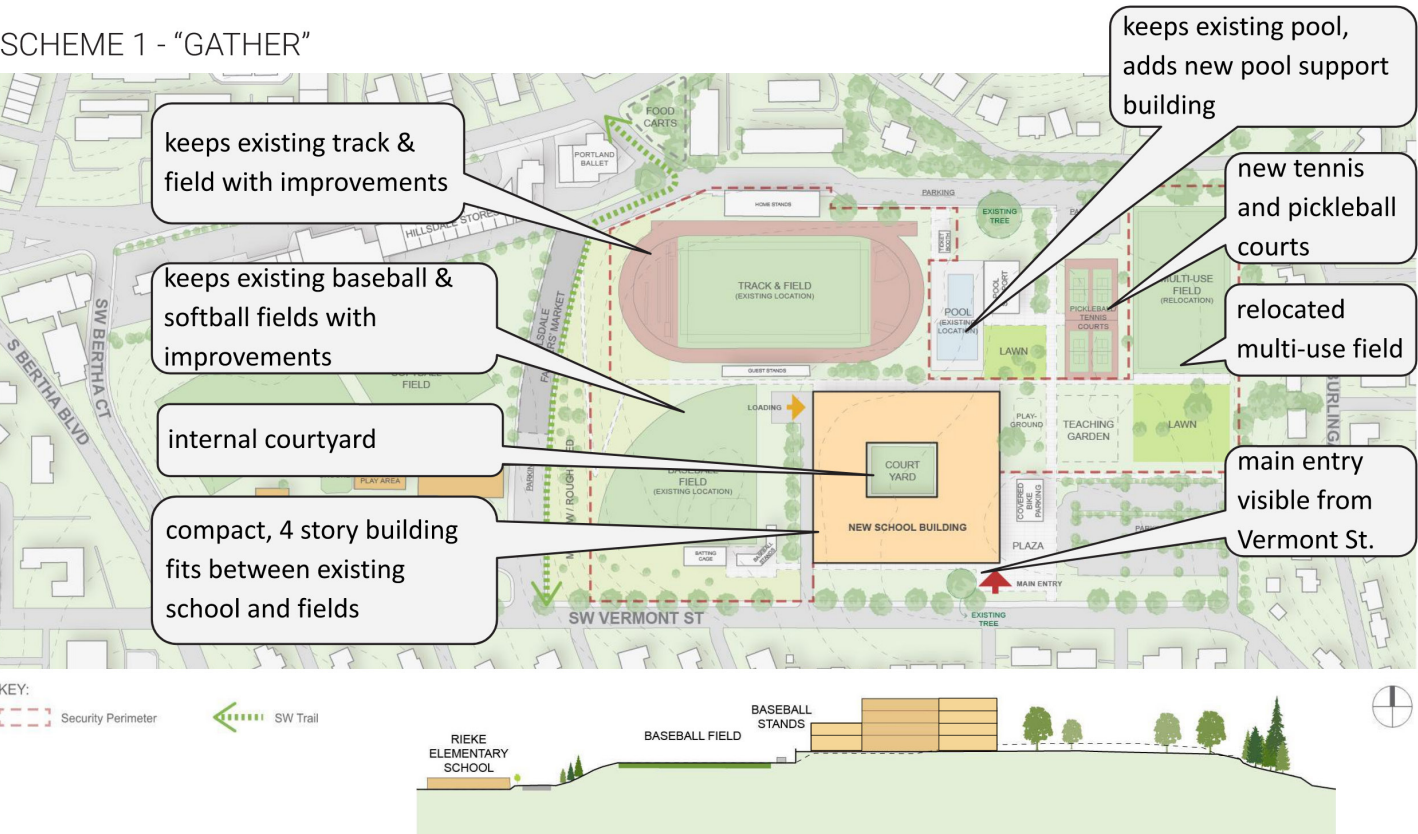

Site Options

Option 2 "Lift"

- Building form steps up with the typography of the site
- Keeps the track/field in same position, moving grand stand to South side
- Keeps pool in the same locations
- Moves the Baseball field to NE corner
- Softball field improved
- New multi-use field on East
- New pickleball/tennis courts south of the pool.
- Parking is similar to Option 1, but with larger southern lot,
- More densely locates sports related functions than Option 1

Discussion

- Would there be any rooms without windows?
 - + There might be some but would be minimized as much as possible.

Option 3 "Connect"

- Greatest level of site intervention
- Optimal Track & field orientation
- Baseball on NE side
- Everything except fields next to Rieke are moved around.
- Building is oriented N/S
- Pool is in the SW conner, accessible from Vermont
- 3 Story scheme
- Larger pedestrian plaza to the North
- Larger parking at the North, smaller lot in the South, though more even in size.
- By relocating the pool out of the center of the site and allows for more outdoor spaces that can be used for various outdoor activities.

Discussion

- Is there a cost difference between the school schemes
 - + Stefee noted that the majority of the cost is the school and each scheme is a similar building size, and the rough cost information is in development.
- Student thanked for adding the connect to Capitol Hwy for commuter.
 - + 4K riders of this line on Capitol Hwy

- Is it assumed in all schemes that students remain in building during construction
 - + Yes
- Does the Ed Spec require an amount of parking?
 - + Erik noted that the Ed Spec does not, parking is governed by local codes
 - + Corey noted that the Climate action policy does note limiting parking and providing access to power charging. Carbon emission goals do include both district vehicles and transportation to and from the school.
 - + When there is no parking, students just park in the neighborhoods
- Is Option 1 more sustainable?
 - + Corey noted that the level of sustainability of each scheme is similar, and it will really depend on the orientation of spaces within each layout. Carbon considerations will be part of the next step in analysis.

3D view shows possible connection through the building E/W

- Where are the pool and North bandstands are within their life span
 - + A: On other schools grand stand replacement is common, but an assessment has not been done.
- Secure Perimeter is closed during school hours. Red dashed lines on plans is a suggestions

SCHEME 2 - "LIFT"

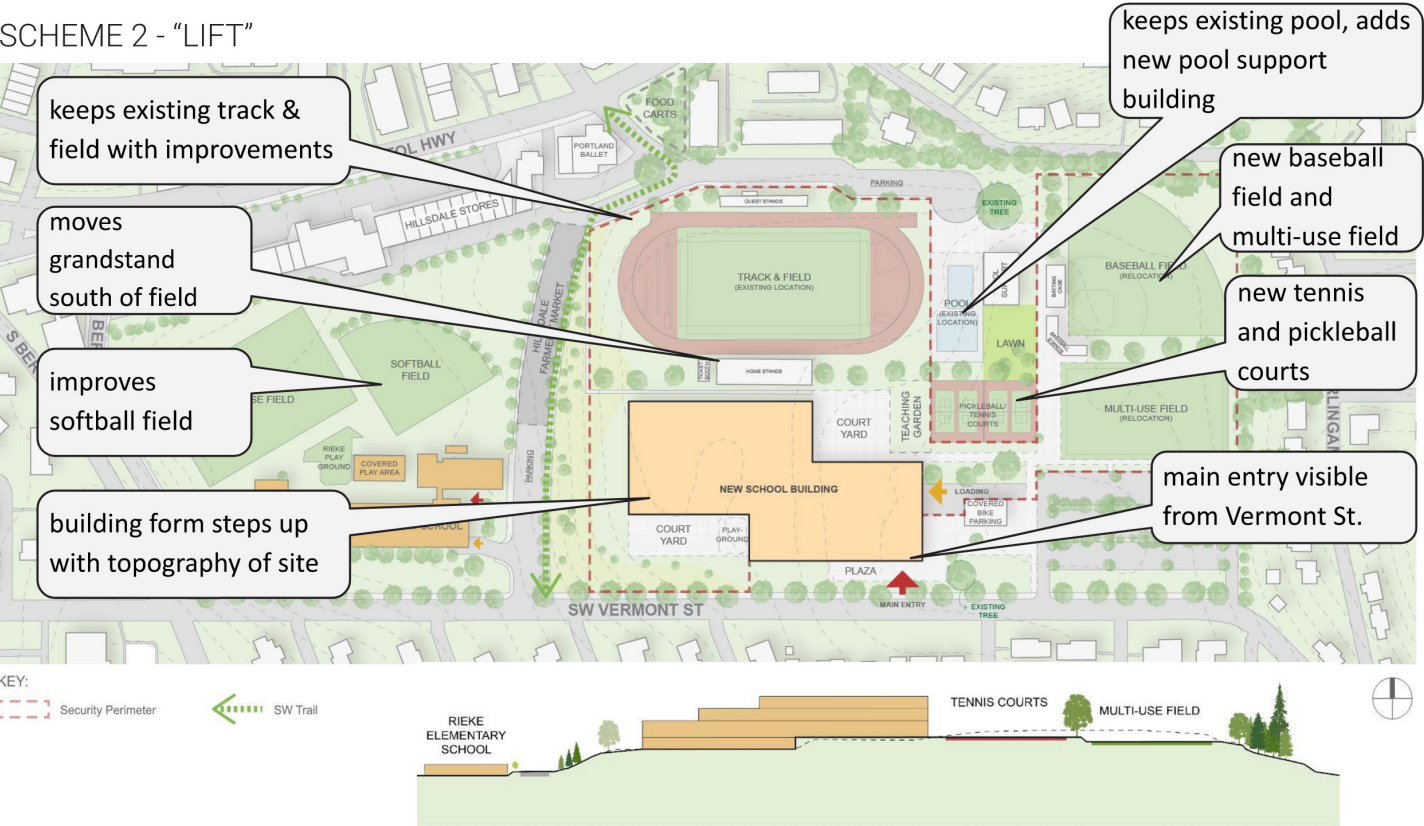

SCHEME 3 - "CONNECT"

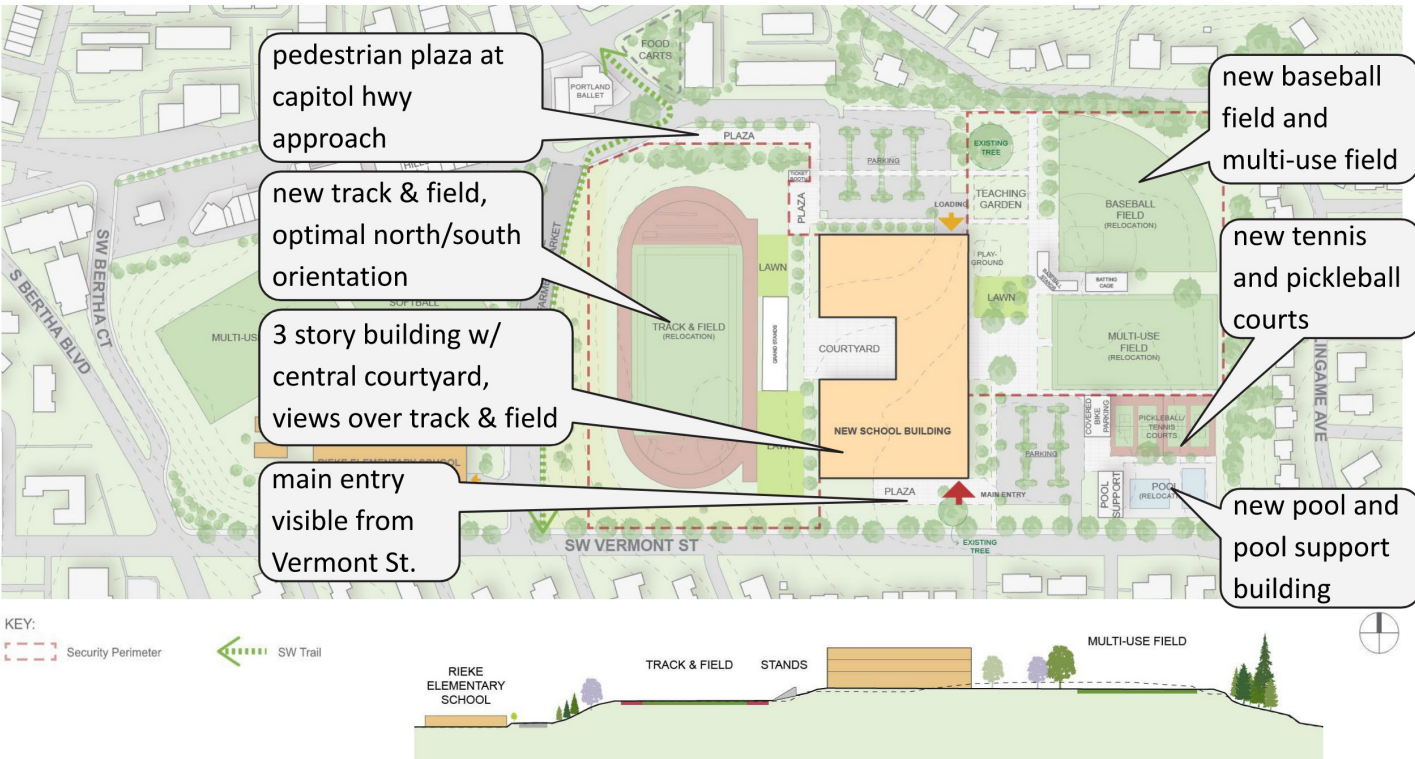

WORKSHOP - CPC COMMENTS - OPTION 1 “GATHER”



- Clear entry and securing use of facilities during project. Courtyard · Disconnect from sports facilities
- Don't like splitting the fields - like main entry / plaza - No entrance off Capital (plaza/feel)
- Successful - smaller footprints / Favorite - Baseball remains / Unsuccessful - Loading dock / TOO MUCH LAWN
- Gather Successful significant reuse of existing structure, however I don't think people like it
- "Gather" not successful Do not like the lack of connection to Capitol entrance
- Gather favorite like inner courtyard and the way all sides overlook it
- Successful > ? > nothing really my favorite -> Layout is funky.
- ON ALL Alternative walkway - Trail along North ENTIRE WIDTH FROM NE corner To CAP Hwy
- Not a good loading concept Curb cut needed, cuts pedestrian side walk, long single purpose driveway.
- Like the small Footprint and Interior courtyard
- Not successful Community thoroughfare
- De-emphasizes Capitol Highway side which Is a mistake in terms of where a lot of the student, pedestrian, bike and car traffic is coming from
- Successful Self contained courtyard that is secure
- POST # PARKING PLACES ON EACH ALTERNATIVE.
- For each design- what is the square foot footprint of the space?
- ENTRANCE S/B. NORTH & SOUTH.
- For each Design Where is the loading Dock and flow for service vehicles
- successful / favorite lots of open field space that is not athletic
- need to maintain enough parking for staff

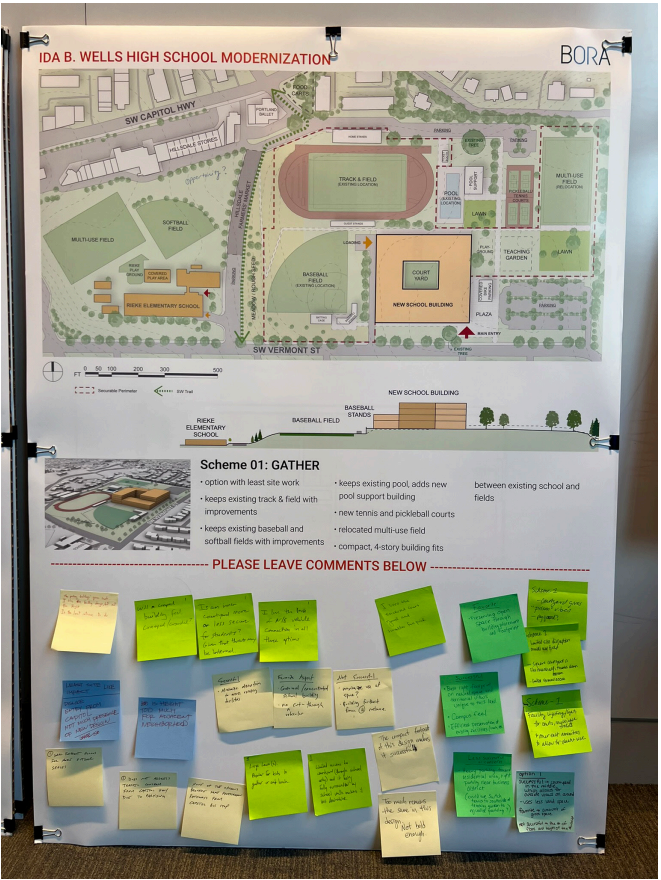

- Courtyard gives “prison” vibes - playground?
- I LOVE the enclosed courtyard and Smaller fo0t print.
- Favorite · Preserving Open Space through building placement and footprint
- Is an inner Courtyard More or less secure for students? Given that threat may be internal
- the parking backlog's gonna suck; I like the building design, but not the height; Is the least intrusive to do
- I love the lack of N/S vehicle connection in all three options
- ‘ - will a compact building feel Cramped/ Grounded?’
- limited site disruption; multiuse field - square courtyard is like Marshall, thumbs down Benson - Limited Vermont Access
- Successful · Best light foot print on natural space and territorial views Unique to this land. · Campus feel · Efficient preservation of existing facilities (track, etc
- Not Successful' maximize use of space?· Building further from entrance.
- LIKE - LEAST SITE IMPACT.DISLIKE - ENTRY FROM CAPITOL NOT MUCH PRESENCE OF NEW DESIGN
- Successful Favorite Aspect · Minimize direction Contained / concentrated to access existing facilities School building · no cut - through vehicular
- IS HEIGHT TOO MUCH FOR ADJACENT NEIGHBORHOOD
- Facility lighting/lights for courts, multiuse fields & other east amenities to allow for District use
- The compact footprint of this design makes it successful
- Less successful or concern - Heavy parking toward residential area, light parking near business district (could we switch tennis to southside of teaching garden to equalize parking ?)
- Limited access to courtyard (through school only) and it being fully surrounded by School walls makes if less desirable.
- Large Lawn (s). Popular for kids to gather or eat lunch.
- SMALL FOOTPRINT ALLOWS FOR MORE OUTDOOR SPACES
- successful -> courtyard in the middle which allows for outside views all around- uses less land space favorite amount of green space less successful - the # of floors and height of the building
- DOES NOT ADDRESS TRAFFIC CONCERNS FROM CAPITOL HWY DUE TO PARKING
- NONE OF THE OPTIONS PROVIDE SAFE PEDESTRIAN PATHWAYS FROM CAPITOL BUS STOP
- Too much remains the same in this design Not bold enough.

WORKSHOP - CPC COMMENTS - OPTION 2 “LIFT”



- Not successful: Community thoroughfare
- Successful: Location baseball Practice Field Favorite -School Orientation No Successful - 2 Stands Pool Stays
- Loading dock seems real inconvenient and puts the bike covered area as an “afterthought” or deemphasizes it
- Successful Practice Field + BB Field located closely Favorite - Perimeter fence Unsuccessful Foul balls The pool
- successful Do not like lack of connection to Capitol entrance
- LOVE the two courtyards and the ample # of N/S Facing classrooms
- successful many different options of varied outdoor gathering spaces
- missing an opp. to have a plaza / entrance off capitol (swap lawn /pool around?)
- like the 2 courtyards * like the building layout & use of the slope Don't like splitting the fields- option to move around ?
- Park-like area on the East side for the neighborhood. is great
- I like how parking is connected to fields, and will create a big view on coming into the stadium.
- I don't like the baseball field being on top of the hill where opportunity for an amazing view is highest!
- Utilization of slope, light, and house design era · The building has cool courtyards and the design reminds me of a daylight ranch . Track & field orientation
- successful: isolated athletics to one portion of site
- could have N-S across campus east of building
- Good opportunity for native plantings, more Site-oriented building, set deep into the hill. Dig into the hill? Underground parking
- Success DESIGN DROP OFF MUCH CLOSER TO CAPHWY -NOTE LOCATION OF FOODCARTS



- Successful:· Preserves pool + track· Campus feel
- Successful: Least disruptive to existing facilities
- Can a bus turnaround @ north access @ baseball field?
- IS IT POSSIBLE TO UTILIZE THE ROOF OFTHE TIERED DESIGN FOR COURTYARD/ GATHERING?
- How DO TIERED BUILDINGS ACCOUNT FOR REFLECTIONS FROM SOLAR COLLECTORS?
- Can we PLEASE have Less parking and more green Spaces? Kid, can ride the Bus, WALK, and BIKE
- LIKE TERRACED DESIGN CONCEPT.POOL SEPARATES THE (2) LARGE FIELDS
- Favorite:· More Spread out built learning environment · More balance: baseball & m/u field co-located · no vehicle cut through
- Where is the gym? theater?
- DOES PROXIMITY TO THE ELEMENTARYSCHOOL EFFECT THOSE STUDENTS AT END OF DAY? (DUE TO PEDESTRIAN TRAFFIC)
- 1) optimizes the whole space , pool is on a main location 2) all sports fields/Services are connected- public use spaces aretogether and away- concern(s) -> No guest stands
- Not successful - Eliminates the Special territorial views of this Unique site - Appears to encourage traffic toward Rieke + residential
- ‘ - Better position for the outdoor locations-The school design has potential- Garden is kinda very hard to see’
- + disruption of existing site + building use of topo / built into site grading + public ?? access during school hours
- Not Successful: - a little disjointed feeling - school building furthest from N entrance.
- Not Successful:- Building looms over Rieke- Ignores community concern of putting high school students too close toK-5 students(Does not supportour elementaryStudents)
- Open courtyards give more access to them as well as views of things other than school walls
- School is more horizontally expansive, possibly increasingly travel the to-and-from classes, and around the perimeter of the school.
- The Track & field and pickleball / tennis courts being closer to the school offer easy access for PE. Classes who use those spaces.

WORKSHOP - CPC COMMENTS - OPTION 3 “CONNECT”



- Underground parking garage (Community use and “pay to park”) maybe.
- No baseball on the hilltop
- Pool relocation is best on this one.
- Why not build it diagonally on the site ? In the “ upper tray.”
- + SW Capital approach+ pool site relocation, ease of public access - [neg] building courtyard is outward taking away from other ?? amenities- [neg] N/S orientation of track/field/stadium
- Parking north and South makes a lot of Sense
- This building seems the best orientation for space, views , access
- Not successful · Separate pool + tennis from students by parking lot
- Can the parking lot and covered bike space be switched so bikes are closer to the building?
- Successful -- Balance! - Prominence! · Great sport for track! centering building on Campus Favorite Aspect connection to N entrance · location of track pushing athletic facilities to each side ... integration of track w/ building Not Successful · pool next to my house?
- Flip main entry and loading dock.
- APPRECIATE THE SETBACK OF THE BUILDING FROM VERMONT
- BALANCE OF FIELDSW/ NEW BLDG [LIKE]
- BLDG VISABILITYFROM VERMONT & SW CAPITOL [LIKE]
- ‘keeps the base design of the school ??- Courtyard is cool- Parking ??part 2’
- Not successful · Heavy disruptive impact on residential area (light + noise) of track & field. · Heavy negative traffic impact on Riche & residential streets during
- DISLIKE GRANDSTAND LOCATION.COULD IT BE FLIPPED TO.WEST SIDE ?
- Easy access to school entry from Capitol Hwy side is wanted / needed by a West student population.
- POOL / PICKLEBALL CLOSER TO NEIGHBORHOOD[LIKE]
- Successful, - tiered building main entrance is very clear parking on both sides-favorite &
- Not successful- May raise concern from voters on expense to build new pool +track[even if not materially more expensive inreality, it absolutelylooks like more \$\$]
- Open courtyard gives more access to it as well as views of things other than school walls .

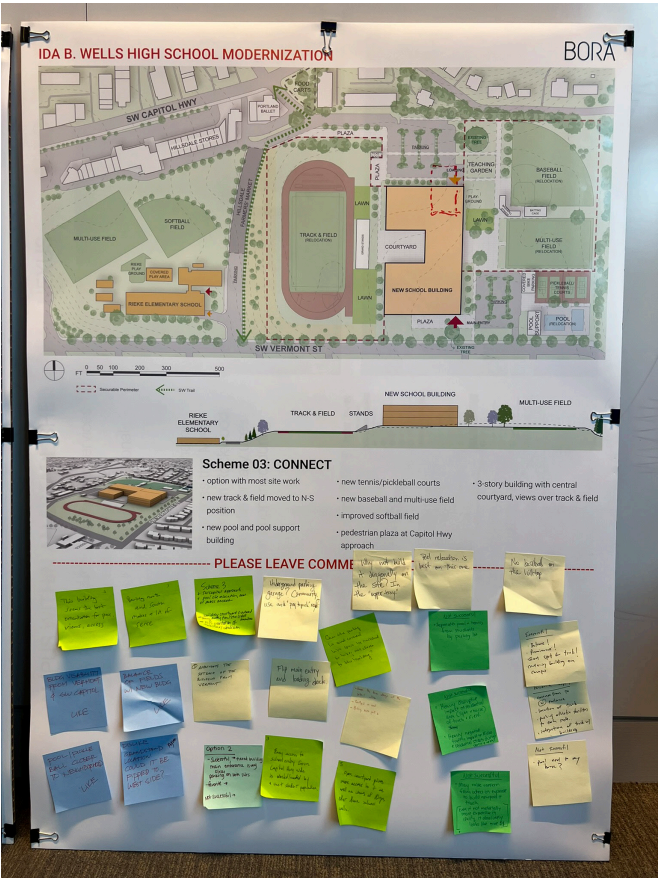

- Connect not successful: spectators facing east is much preferred too many east facing classrooms?
- like the entrances on both sides - like Plaza off Capitol - don't like splitting the fields . - like the idea of moving the filet football field to a N/S option. - like a plaza on each side of the School entrances - like parking lots on both sides'
- Connect Successful far prefer the N/S orientation of everything& the connection to Capitol Hwy
- Connect Favorite! just love the relationship from school to courtyard to field w/the resulting view!
- Success -Better Layout Pool Moved Field moved N/S-> Grandstands move to West
- Like the re-oriented track and Field stadium and the feel of the campus- Lower/fewer stories keeps the profile of the building down- Better use of the gracethe site'
- Better grouping #For Garden, Baseball field Multi Use field, tennis/pickleball court Pool! Like the Pool on the “community side” ofthe facility
- Best loading dock location. Vehicles will need to have better swing clearance for then
- Not successful: Community thoroughfare Potential is best of the three
- Like the greater emphasis on the Capitol highway Side for traffic and parking Better access to the track and field and the baseballfields
- Favorite Successful - Fields - No Foul balls in pool Unsuccessful- FB Stadium Facing West
- IMPORTANT, TREE
- NEED N ENTRANCE.NEED PED ACCESS N/S ONEAST SIDE
- Like the courtyard and Lawn plaza between the school and the track & field. The plaza in the front, Could be bigger
- Not Successful main entrance needs to be more centrally located to accommodate capital highway traffic
- ?? ADDED COSTOF RELOCATINGFB FIELD, ??
- not Successful School looks at back of grandstand, disrupts view
- Creates lovely spaces to enjoy the outdoors & views· Relocation of track & field· Is the new pool location in the shade?

WORKSHOP - ADDITIONAL CPC COMMENTS RECIEVED AFTER MEETING

GATHER: (ranking #2 of 3)

Pros -

- Minimal footprint change/disruption
- Easier security as is aligned to single street access
- Prevents significant pass-thru, as crossing campus isn't convenient
- Economized Athletics access for programs
- Optimal N/S field orientation for multi-use athletic field

Cons -

- More difficult access for students arriving from Hillsdale bus stops
- Significantly increased traffic on Vermont
- Primary parking distant to athletics venues
- Stadium remains in less-desirable E/W orientation
- Higher skyline profile

LIFT: (ranking #3 of 3...by some distance)

Pros -

- Easy loading access
- Centers community amenities
- Decent flow across campus
- Lower skyline profile
- Lowest western exposure for heating/cooling

Cons -

- Towers over Rieke
- Biggest spread of athletics venues
- Most difficult building access to students on foot from Hillsdale
- Centers community amenities over school/student amenities

CONNECT: (ranking #1...by a considerable distance)

Pros -

- Similar campus feel for historical continuity
- Similar building shape for same historical continuity
- Superior walking access to Hillsdale for students on foot from bus
- Appropriate placing of community amenities (fringe corner of campus)
- N/S field orientation for stadium
- Grand courtyard (staired?) entry for aesthetics
- Easiest for room layouts...maximum flexibility on entries, loading, etc.

- Marginal fire safety improvement, as fire can access most of building from Hillsdale directly (location of station)

Cons -

- Lots of west-facing walls for heating/cooling needs

GENERAL:

- If it's not too early in the process, I'd also like to share some input on some ideas from someone who is a very knowledgeable stakeholder (teacher, facility 'manager', parent, community member) of nearly 20 years.
- -I'd like to propose a standalone Performing Arts/Visual & Performing Arts Center on the campus. Community use of facilities has come up multiple times, and IBWHS has a robust and historical connection to the arts. I'll send more robust thoughts in a separate email.
- -It's unclear why there's a playground onsite in the proposed plans. We've not had a youth presence on campus (pre-school, day care, etc.) in many, many years.
- -A small amphitheatre-like bowl with tiered seating would be a huge addition from the community gathering, outdoor classes, and performing arts points-of-view.
- -Unclear as to the focus on the 'teaching garden'. Our garden, as it stands, was the singular project of one of our now retired teachers, and has not been used since in any notable way.
- -The lack of a vehicle pass thru/pass around is a major plus from the staff standpoint. The parking lot was never intended to be a street/thoroughfare.
- -From a community standpoint, the pool is a reasonably big deal; from the staff standpoint it is an inconvenience and an eyesore. If it is to remain, decentralization would be nice.
- -While I know we are in a moment where 10000 foot view, and grand, general vision pieces are our primary focus, the main interest of rank-and-file staff members is practicality: Access, Functionality, Traffic, Interplay between Programs/Events, Storage, Security, Maintenance/Custodial, Gathering Spaces, HVAC/Environmental controls, and the like. Things like environmental sustainability, walkability, trails access, community amenities, front-facing multicultural elements, etc. are all good conversations to have at this point, but ultimately less impactful on our primary mission: educating students. It is my hope, as a parent of future IBWHS students, a student-events director/coordinator, and a teacher who intends to be here another 15+ years, that this will be our primary focus in future, more

WORKSHOP - DISCUSSION

OPTION 1 - GATHER:

- Compact - will it feel cramped or crowded?
- Disliked the access from Capitol, does not address from north
- No bold enough
- Light footprint
- Where is the loading dock? We are starting to think about this.
- Need to maintain parking for staff
- Successful smaller footprint
- Self-contained courtyard is successful
- Lots of site that is not taking by sports is successful
- Summary: Compact is successful; more connection to Capitol

OPTION 2- LIFT

- All athletics are connected
- Building has longer path of travel
- No vehicle cut through
- Disjointed feeling
- School furthest from North
- Like terraced concept
- Eliminates that views of the site
- Looms over Rieke
- Encourages traffic at Rieke and Vermont

OPTION 3 - CONNECT

- Like connection to Capitol HW
- Greater views
- Not successful - poor spectator view at field
- Best loading dock option
- Successful wrapping the sports and pool to N/E
- Summary: Love for the fields and proximity to North; like courtyard and views

GENERAL DISCUSSION

- Can Roof space be optimized?
 - + Stefee noted that roof top garden spaces are challenging for both maintenance and safety.
- Is a Living Roof be possible?
 - + Corey noted that Lincoln has a green roof and solar panels will be required for this building and both are things to study on this project.
- Solar panels - on the Lincoln site, is power able to store and usable in the future?
 - + Corey noted panels would be usable over time and if battery storage is available





ENGAGEMENT PLAN

AFTER BRUCE INTRODUCTION

- Rhonda introduced After Bruce team, its background and experience.
- Engagement is relational, and is a back and forth communication
- Feedback loop, helps to visualize all the groups involved in the process, and AB is here to facilitate that conversation and communicate directly with community members on behalf of the modernization process.
- Work will include:
 - + Stakeholder engagement, one on one conversations
 - + Community listening sessions
 - + Connecting with historically marginalized communities
 - + Facilitated conversation, focused on collection individuals feedback
 - + Focused groups (see slide)
 - + Can include surveys that will be shared more broadly
 - + DIY facilitation guide
 - + Allows ambassadors to take questions to their peer groups and facilitate feedback sessions to share back with the design team.
 - + Office Hours This work uses an equity lens, strength based and empower folks they talk with, build reciprocal relationships
- Open invitations to the community to allow for questions and answer dialogues



CLOSE & NEXT STEPS

- If you did not get the Bond Email, please reach out.
- Is there a website that lists information on the next Community Engagement website?
 - + Community Workshop will be in the cafeteria, with food!
- Meeting ended at 8:05 pm

